

1907 Dunraven Road  
**LOT 98 DUNRAVEN, 1st Add. ??**

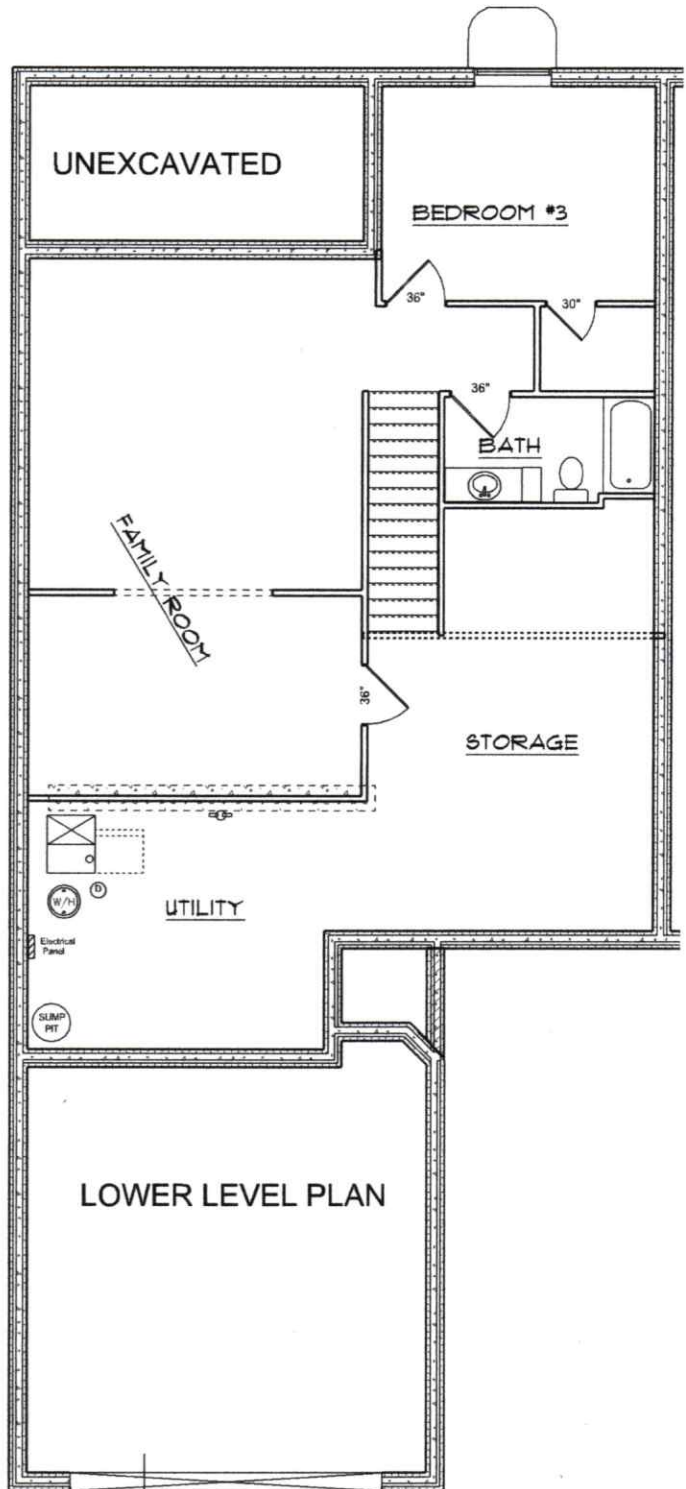

Main	1,504 sq ft
Total Basement	1,504 sq ft
Finished Basmt	322 sq ft
Total Finished	2,426 sq ft
Garage	510 sq ft
Covered	
Front Stoop	20 sq ft
Rear Porch	164 sq ft

